

Please follow these fixing and care instructions to ensure that your product is fitted safely and that it retains its high quality finish. Please retain this leaflet for future reference.

This instruction leaflet applies to the following products:

QM461041 Worcester Mirror
QM441041 Chester Mirror
QM411041 Pendle Mirror
QM741041 Romsey Mirror
QM751041 Wimborne Mirror

Fixing Pack Contents / Tools Required

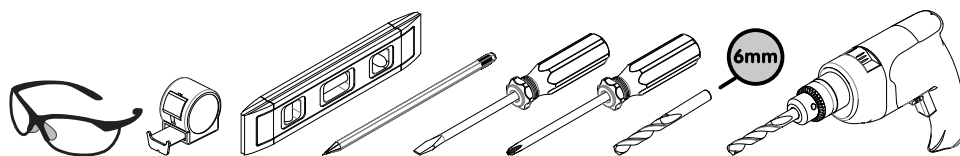
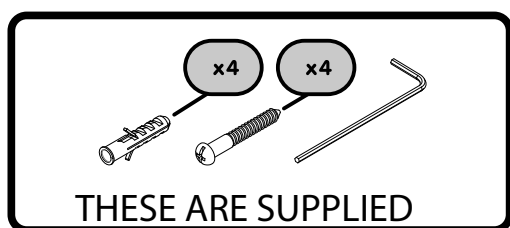

KEEP DIY TOOLS OUT OF THE REACH OF CHILDREN

Home Safety Advice

It is recommended that two people fit the mirror to ensure that it is fitted safely.

Always take care when using power tools, particularly in the bathroom.

Always check for hidden cables and pipework before drilling and take extreme care if there is any water in the working area.

It is advisable to use a residual current circuit breaker (RCCB).

Always wear suitable eye protection when drilling.

If the product is to be fitted on a ceramic tiled wall, a ceramic drill bit should be used.

Always ensure that the drill hole passes through the central tiled area rather than through the grouted area. To prevent damage to the tile, mask the area around the hole with tape before drilling.

Do not strike the product with hard or sharp objects.

Do not position glass components in close contact with a heat source.

Product Care

To retain the best quality finish, clean product regularly with a soft damp cloth.

Do not use abrasive or chemical cleaners, as these will damage the product.

A MIRROR INSTALLATION

- 1 Place the mirror in position on the wall surface and use as a template to mark the hole centre positions.

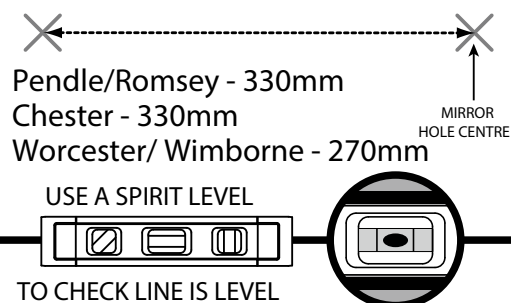

- 2 Ensure the mirror hole centre marks are located in the middle of the wall plate and using a pencil, mark the screw hole centres for the wall plates 30mm apart.

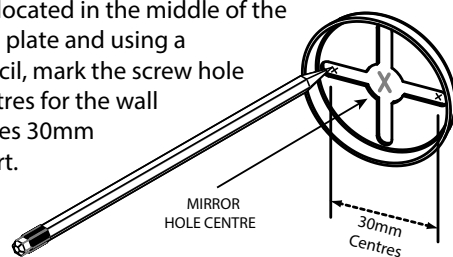

- 3 Drill holes

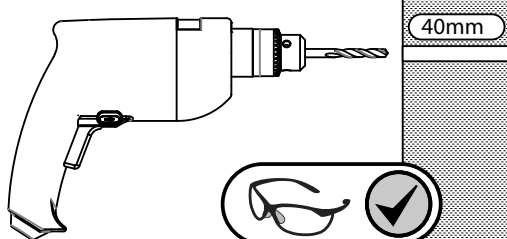

- 4 Insert wall plugs into the wall and fix the wall plates tightly into position using the screws supplied. Before tightening screws ensure the mirror hole centre marks are located in the middle of the wall plate.

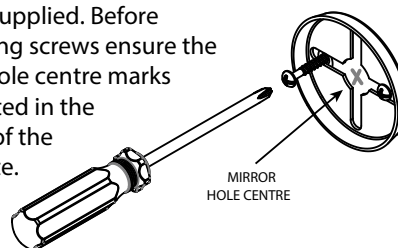

NOTE

Wall plugs supplied are suitable for a solid wall fixing only. For cavity walls or plasterboard use specialist fixings available from all good DIY stores.

- 5 Secure pillars to Flexi Fix wall plate by tightening the grub screw underneath.

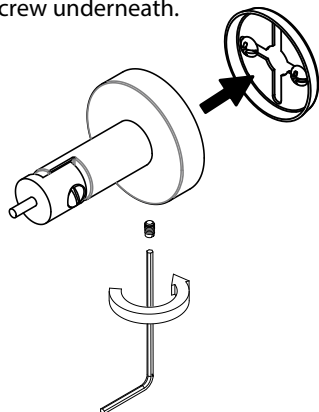

- 6 Locate the rubber grommets (a) into the mirror holes from behind the glass. Carefully place the mirror onto the pillars ensuring the mirror glass holes are aligned with the threaded studs on the pillar. If necessary adjust the pillar positions to fit. Thread the locking bushes (b) onto the studs and push fit the caps (c) onto the bushes to finish the installation.

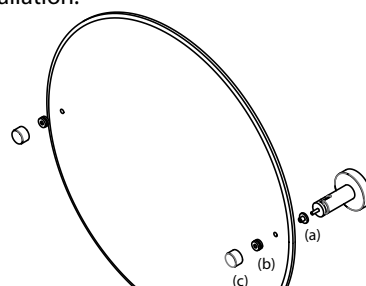

NOTE

DO NOT OVERTIGHTEN the locking bushes onto the threaded studs.

- 7 If necessary tighten or loosen the mirror's tilt mechanism by using a flat head screwdriver.

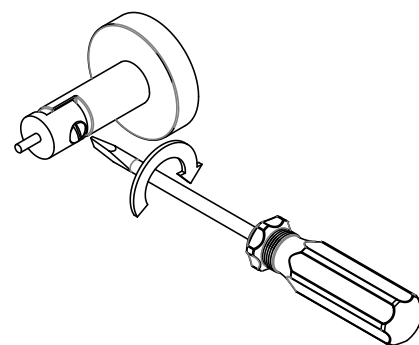

Flexi-Fix is a registered trademark of Croydex Ltd, Andover, Hampshire, UK

Croydex Ltd,
Central Way, Andover, Hants, SP10 5AW, UK
Tel: +44 (0) 1264 365881
Fax: +44 (0) 1264 356437
website: www.croydex.com
Email: info@croydex.co.uk